

# TEXAS POLICE CHIEFS ASSOCIATION

MARCH 27-28, 2018

GALVESTON CONVENTION CENTER AT THE SAN LUIS RESORT - LEVEL 1 EXHIBIT HALL - GALVESTON, TEXAS

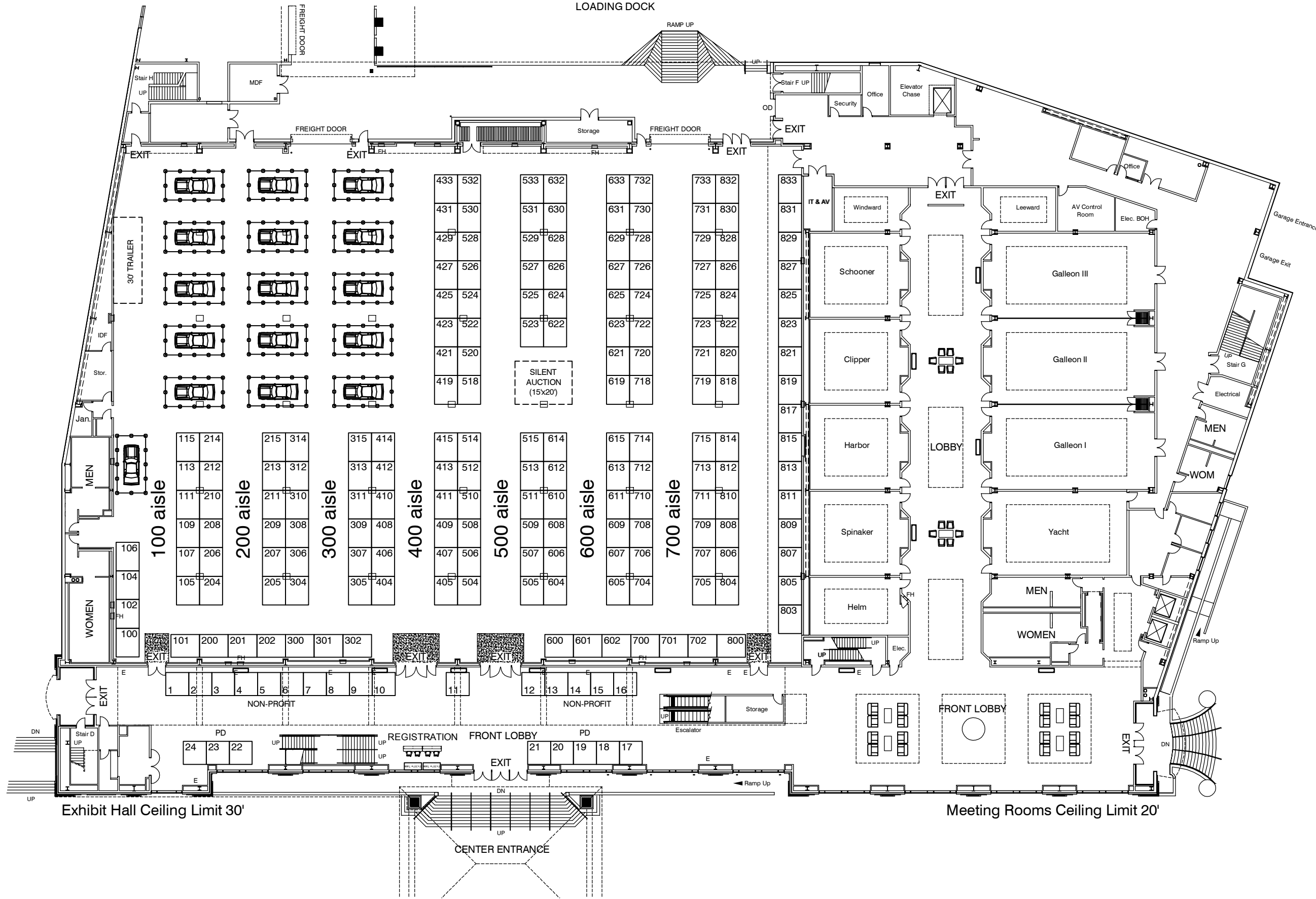

**REVISION**

Date: 12/12/2017  
By: LEWIS HEMPHILL

**BOOTH COUNT**

Inventory as of 01/03/2018

Dimension	Size	Qty	S
8x8	64	24	1,5
8x10	80	178	14,2
<b>Totals:</b>		<b>202</b>	<b>15,7</b>

**BLDG. LEGEND:**

**DRAWING INFO**

Passport Line Item Number:

**#4226777**

Facility:  
GALVESTON CONVENTION CENTER  
AT THE SAN LUIS RESORT

Hall / Level:  
LEVEL 1 EXHIBIT HALL

City & State:  
GALVESTON, TEXAS

Scale: CUSTOM

Job #: 412056

AE: DENA SORSBY

Prod. AE: DENA SORSBY

Started: 12/12/2017

Started By: LEWIS HEMPHILL JR

Prod. Brand: HOUSTON

**FREEMAN**

**Disclaimer** - Every effort has been made to ensure the accuracy of all information contained on this floor plan. However, no warranties, either expressed or implied, are made with respect to this floor plan. If the location of building columns, utilities or other architectural components of the facility is a consideration in the construction or usage of an exhibit, it is the sole responsibility of the exhibitor to physically inspect the facility to verify all dimension and locations.  
© Copyright 2007, Freeman Co. All rights reserved.

**Confidential and Proprietary** - the information contained herein is the proprietary information of Freeman and by accessing the information, the recipient agrees to keep the information confidential and not disclose it to any third party without the prior consent of Freeman. Recipient also agrees to only use the information for its internal evaluation purposes and for no other purpose, without the prior consent of Freeman.

File Path: P:\Houston\Branch\Design\FLOOR PLANS\2018\03-Mar\TX POLICE CHIEFS ASSN (412056)\DWG Files\TPCA 0318 8x10 MAX FP.dwg | Tab Name: 11x17L